

senzor®

## Užívateľský manuál



**Diaľkové ovládanie**

---

**DO - 2**

2 x 1.5V

# 1. Základné údaje

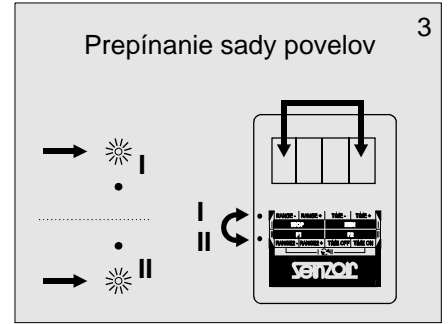
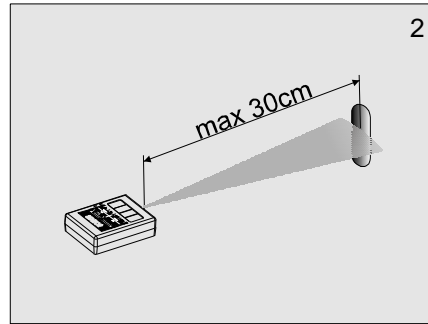
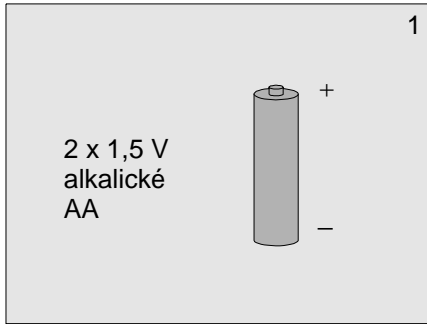

# 2. Nastavovanie parametrov

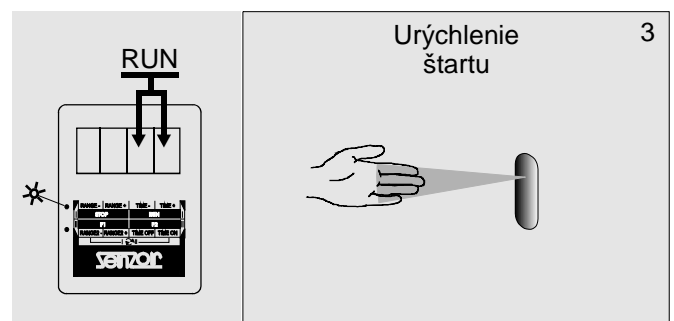
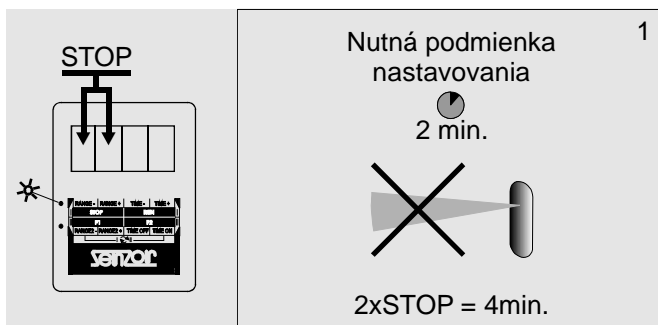
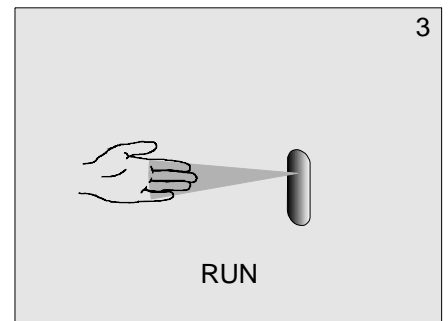
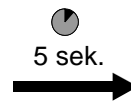
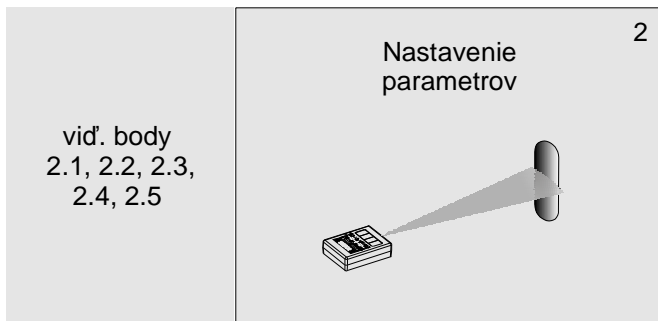
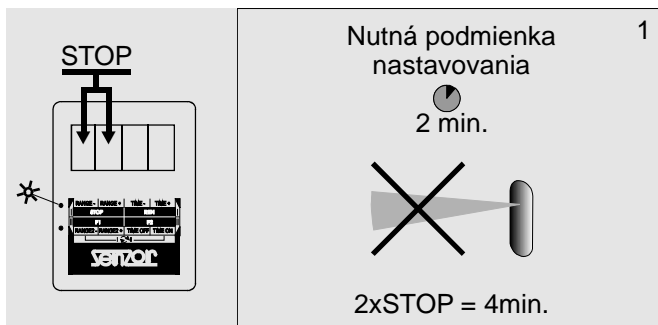

## 2.1. Nastavenie parametrov u snímačov:

TYP 9100, TYP 9200, WBS 2.2, WBS 2.2B, WBS 7.2, WBS 7.2B

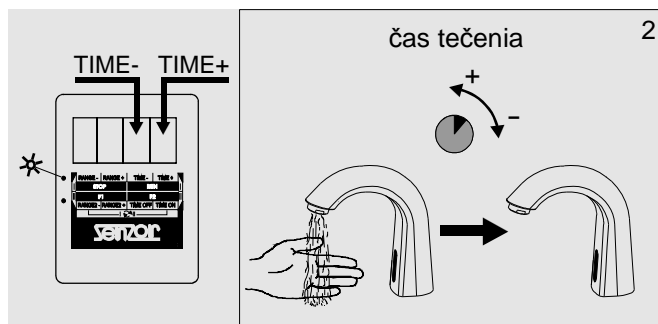
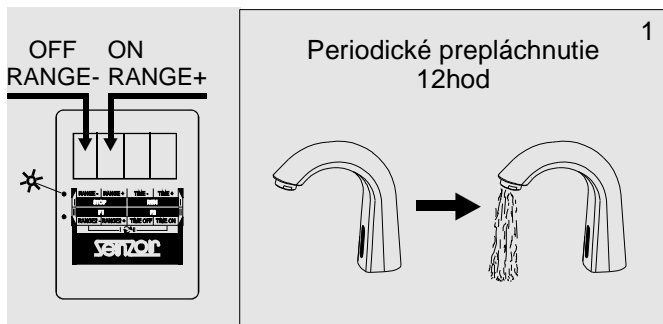

## 2.2. Nastavenie parametrov u snímačov:

WBS 3.1B, WBS 3.2B, WBS 3.1, WBS 3.2

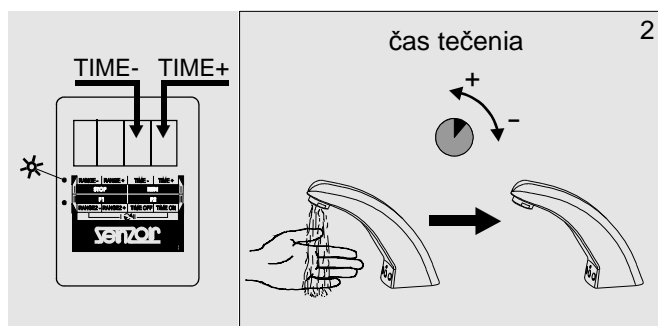
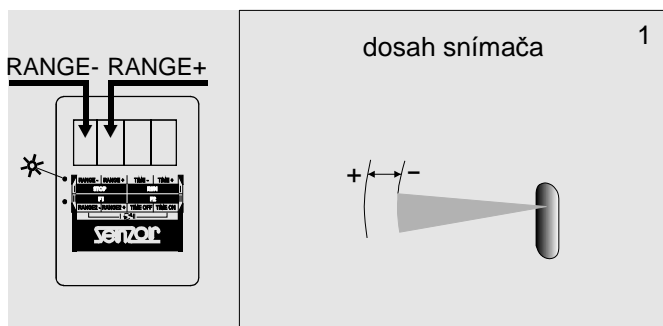

Iba WBS 3.1B, WBS 3.2B

## 2.3. Nastavenie parametrov u snímačov:

WBS 4.1B, WBS 4.2B

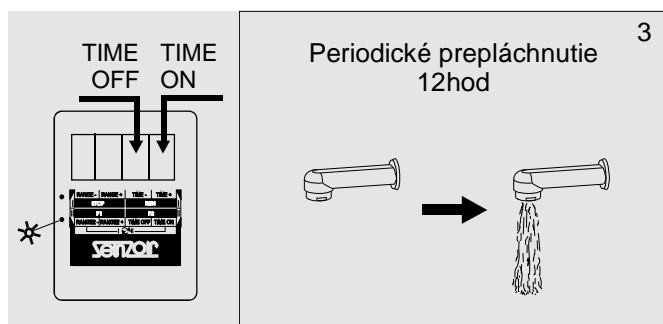
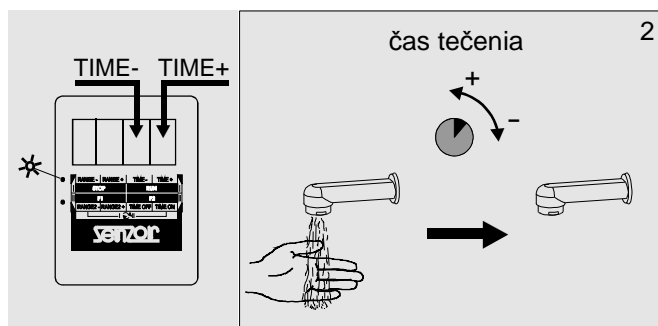
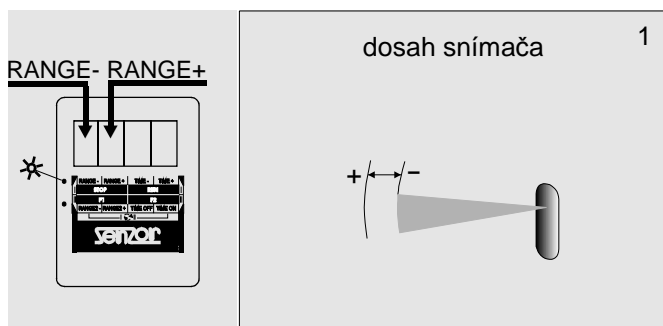

## 2.4. Nastavenie parametrov u snímačov:

APIS 4K1, APIS 4GK1, APIS 4.1, APIS 4B1,  
APIS 5, APIS 5B, APIS D1B1, APIS KP, APIS KK, APIS P1

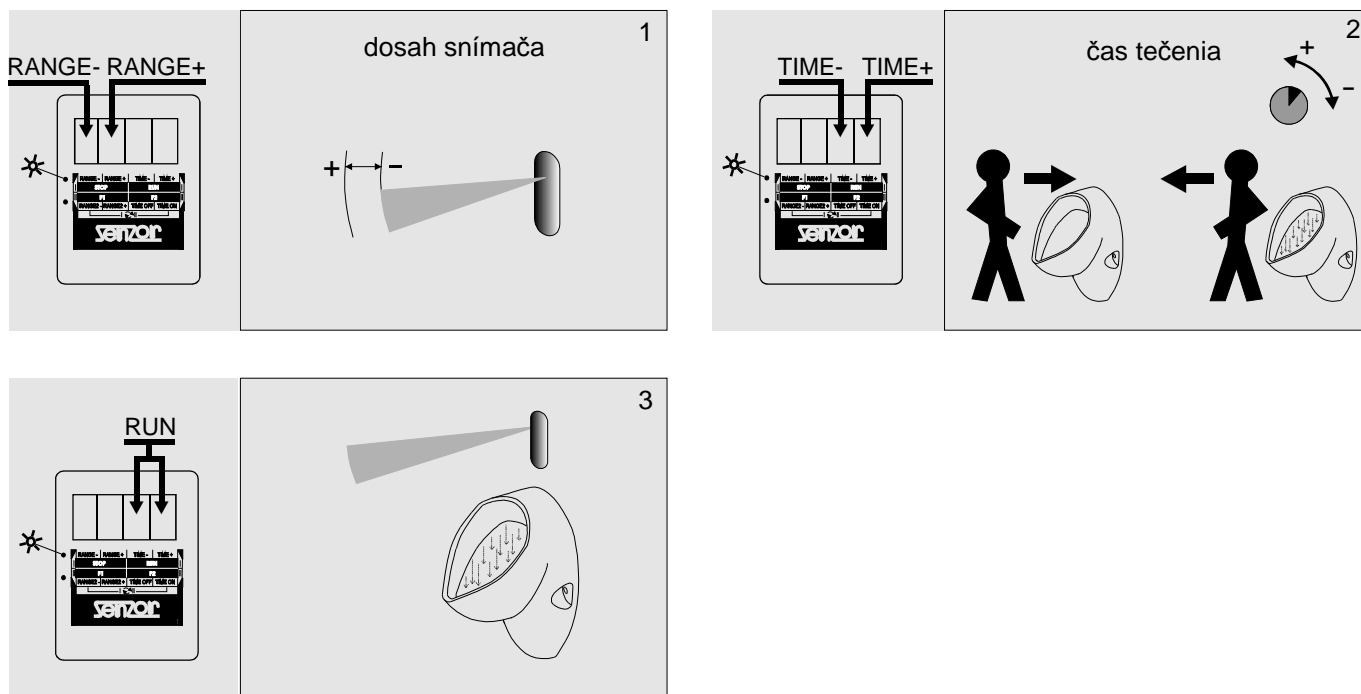

## 2.5. Nastavenie parametrov u snímačov:

SABA 2TLT, SABA 2TLTB, SABA 2NTB:

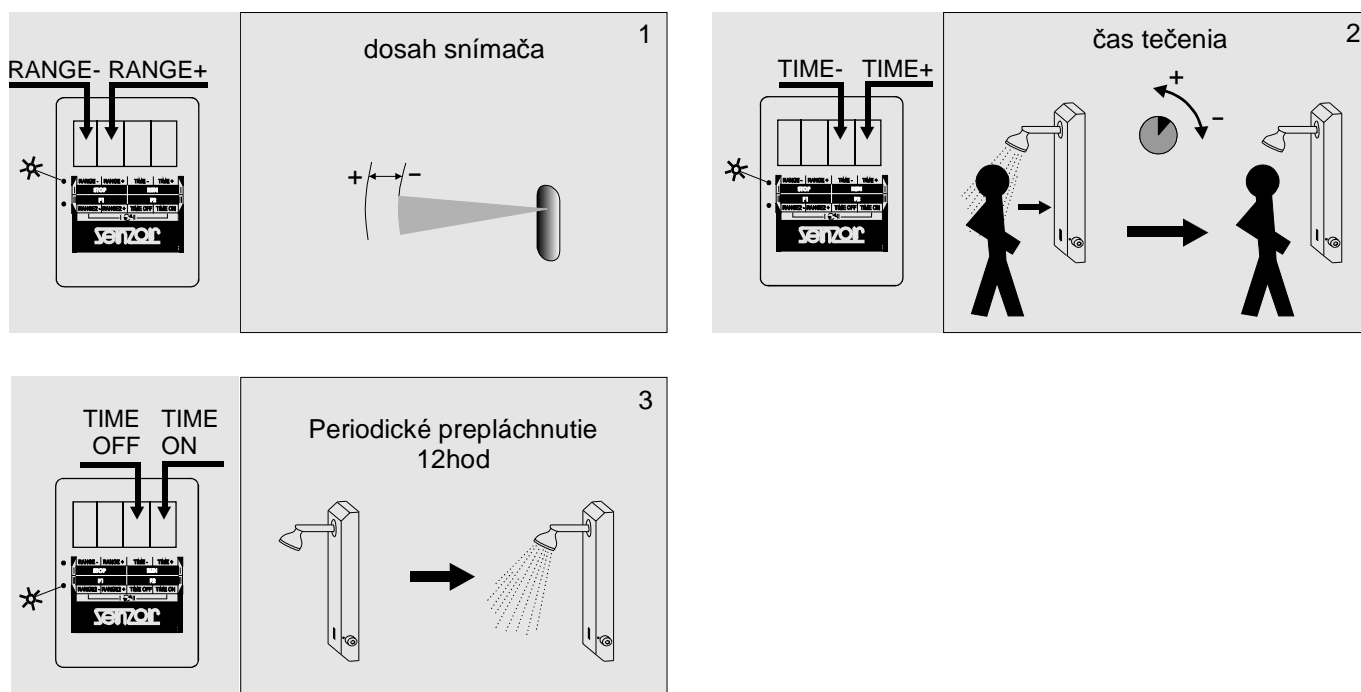

## 2.6. Aktivácia hygienického preplachu u snímačov:

SABA-2NTB.11R, WBS/SABA-P2, WBS-6PTL, WBS-P3, TYP6000B:

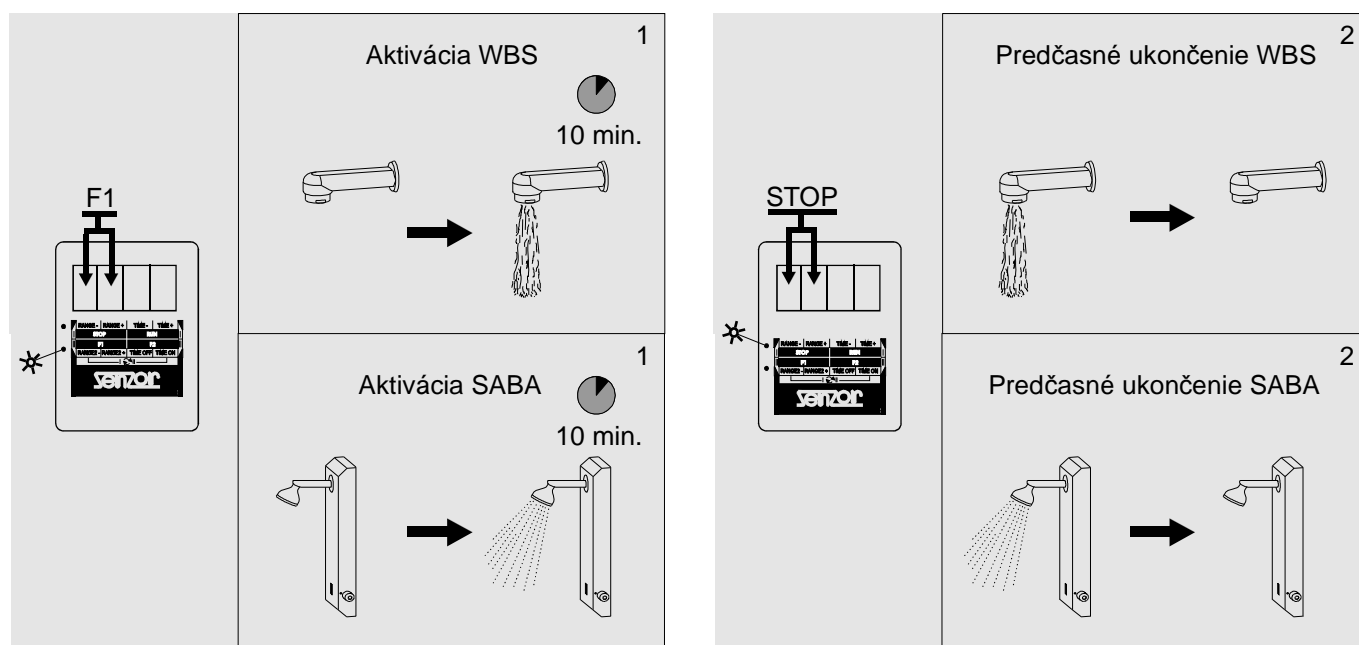

Výrobca: SENZOR s.r.o. Košice  
Park Angelinum 19, 040 04, SR  
Tel.: +42155-622 30 13, 622 40 74  
Fax.: +42155-622 29 02

## 3. Dôležité upozornenia.

CN: 09 02 04-000- DO-2

Diaľkové ovládanie musí byť nasmerované v priamom smere na oko senzoru.  
Pri správnom ovládaní diaľkového ovládania sa zmena na oku senzora potvrdzuje aj blikaním.  
Rýchle blikanie indikuje prepnutie do režimu stop, štart a dosiahnutie krajných hodnôt nastavenia.  
Slabá batéria ovplyvňuje činnosť diaľkového ovládania.